

Model 367 Shift-On-Fly Hydrostatic Transmission

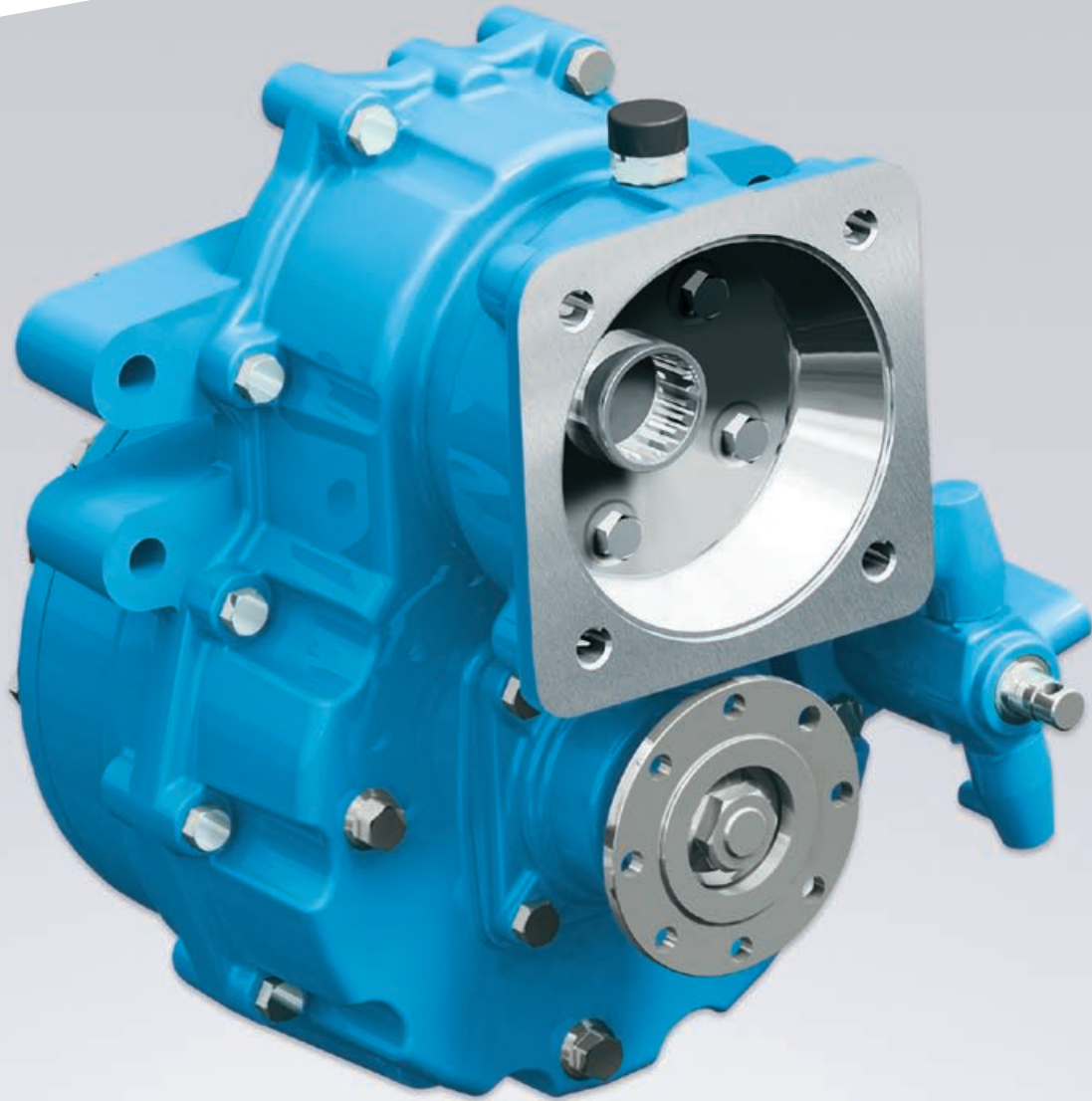

SPICER®
Off-Highway Systems



Mobility for compact
construction, mining, and
material-handling equipment

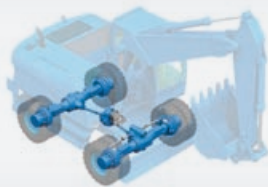

Model 367 Shift-On-Fly Hydrostatic Transmission

Optimized for use on compact, hydrostatic-driven vehicles including wheeled excavators, telescopic boom handlers, and front-end loaders, the Spicer® Model 367 shift-on-fly transmission is designed to enhance vehicle mobility and allow for quick deployment from worksite to worksite.

Design Features

The Spicer Model 367 two-speed, shift-on-fly hydrostatic transmission is extremely compact and versatile, with advanced gear-shifting technology and a wide range of available ratios.

Designed for compact industrial vehicles requiring a slow working speed and a fast speed for traveling, the Spicer Model 367 transmission does not require vehicle standstill for gear shifting and includes a hydraulic motor ranging from 55 to 110cc.

It can be remote mounted or directly flanged to Spicer components.

Featured options:

- Four-wheel drive engagement
- Hydraulic shifting (12 to 28 bar)
- Gear-engagement sensor and speed sensor
- Integrated spring applied, hydraulically released (SAHR) parking brake

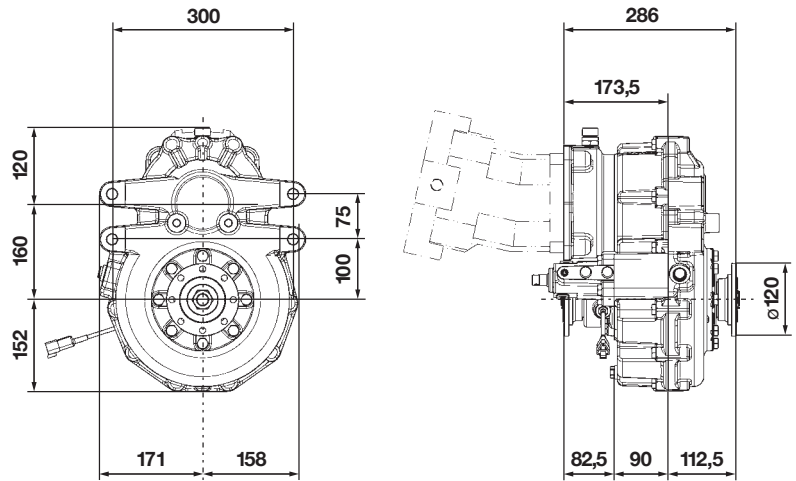

All dimensions are in millimeters

Technical Data	
Input Torque (Continuous)	700 Nm
Input Power	130 kW
Speeds	2 – Shift-On-Fly
Maximum Input Speed	4500 RPM
Ratios Available	1st gear 1:2.03 to 1:4.53
	2nd gear 1:1.09 to 1:1.62
	Spread 1.275 to 4.428
Input/Output Flange	Yoke options – DIN – SAE – mechanics
Weight	60 kg

Sales Office – Italy
Zona Industriale
Arco, Italy 38062
+1 888 670 3262

www.dana.com/offhighway



SPICER®
Off-Highway Systems

All applications must be approved by the Application Engineering Department. Specifications and/or design are subject to change without notice or obligation.